

# OUTDOOR WALL MOUNT 48-120F

## Aluminum Outdoor Wall Mount 48-60 F

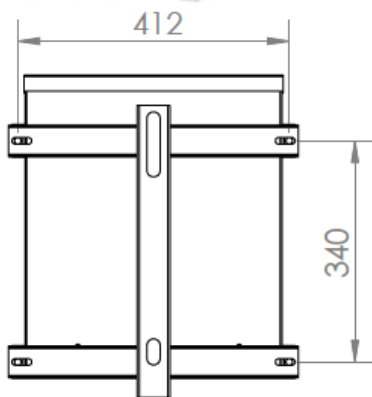

Bracket 48-60F



Splice Tray 12 Fiber

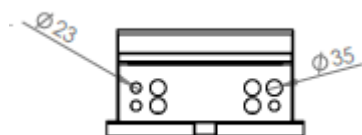

## Aluminum Outdoor Wall Mount 96 - 120 F



## OUTDOOR WALL MOUNT 48-120F

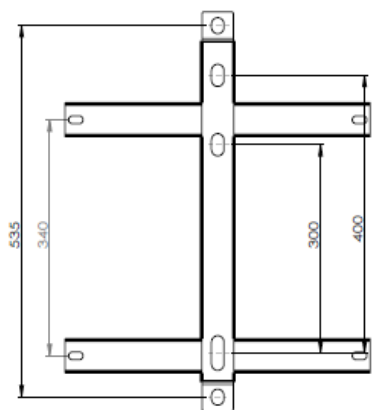

Bracket for ODF 48-60F

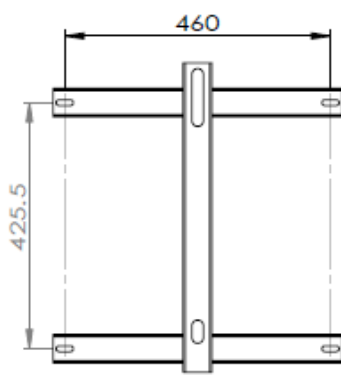

Bracket for ODF 96 - 120F



Splice Tray 12 - 24 Fibers

### Description

Aluminum Outdoor Wall-Mount Fiber distribution box made of Stainless and Aluminum sheet 1.5 mm and powder coated 65 micron. Aluminum Outdoor Wall Mount is available for 12, 24, 48, 60, 72, 120 fiber in the standard beige color., the cable insertion the distributor is pre-punched for PG 21 cable glands optionally, cable can also be insert with connectors. The cable can be held in the preformed holes by a section cable inlet or cable feed through grommet depending on cable diameter.

### Features / Benefits

- Provides easy access for connector FC ,SC ,LC, ST, E2000 panel
- One door lockable and Key IP 65
- IP 65 protected
- 12, 24 splice tray holder
- Panel for adapter can be sliding

Material : Aluminum 1.5 & 2 mm.

Bracket : EG Steel 2 mm

Size: MM.

12 - 24 PORT	=	124.5 (D) x 408.5 (H) x 350 (W)
48 - 60 PORT	=	155 (D) x 486.5 (H) x 390 (W)
72, 120 PORT	=	184 (D) x 616.5 (H) x 440 (W)



## OUTDOOR WALL MOUNT 48-120F

Product Code : with Bracket

CODE	Product Type	Capacity	Packing	Net Weight	Gross Weight
JK ODF0012	ODF 12F Outdoor Wall	12 Fibers	1 set/box	6.05 kg.	7.45 kg.
JK ODF0024	ODF 24F Outdoor Wall	24 Fibers	1 set/box	6.10 kg.	7.50 kg.
JK ODF0048	ODF 48F Outdoor Wall	48 Fibers	1 set/box	8.85 kg.	10.25 kg.
JK ODF0060	ODF 60F Outdoor Wall	60 Fibers	1 set/box	8.90 kg.	10.30 kg.
JK ODF0072	ODF 72F Outdoor Wall	72 Fibers	1 set/box	11.25 kg.	12.65 kg.
JK ODF0096	ODF 96F Outdoor Wall	96 Fibers	1 set/box	11.95 kg.	13.35 kg.
JK ODF0120 D	ODF 120F Outdoor Wall	120 Fibers	1 set/box	12.00 kg	13.40 kg.

Product Code : Pigtail + Adapter FC + Bracket

CODE	Product Type	Capacity	Packing	Net Weight	Gross Weight
JK ODF0012	ODF 12F Outdoor Wall	12 Fibers	1 set/box	6.35 kg.	7.75 kgs
JK ODF0024	ODF 24F Outdoor Wall	24 Fibers	1 set/box	6.70 kg.	8.10 kgs
JK ODF0048	ODF 48F Outdoor Wall	48 Fibers	1 set/box	10.00 kg.	11.40 kgs.
JK ODF0060	ODF 60F Outdoor Wall	60 Fibers	1 set/box	10.35 kg.	11.75 kgs
JK ODF0072	ODF 72F Outdoor Wall	72 Fibers	1 set/box	13.55 kg.	14.95 kgs.
JK ODF0096	ODF 96F Outdoor Wall	96 Fibers	1 set/box	14.25 kg.	15.65 kgs.
JK ODF0120 D	ODF 120F Outdoor Wall	120 Fibers	1 set/box	14.90 kg	16.30 kgs.

### Specifications No.: CDD-ODF-IUTDOOR-001

#### TECHNICAL SPECIFICATION

- (1) Outdoor ODF used for outdoor applications and shall be install outdoor on concrete pole or wall. (Include accessory for install on concrete pole and wall)
- (2) Outdoor ODF shall be totally protected against dust and protected against strong jets of water. (Same as IP65)
- (3) Outdoor ODF shall support the termination of 48 fibers or better which have 24 fiber per splice tray or better and individual removable each splice tray outdoor type
- (4) Outdoor ODF shall support adapter type at least FC, SC, LC, ST
- (5) Outdoor ODF shall have cable entry at the bottom not less than 4 ports use cable glands. And Provide rubble sealing 4 mm thickness for water protection.

## OUTDOOR WALL MOUNT 48-120F

- (6) The dimension of Outdoor ODF should be less than or equal to (W) 390 mm. x (H) 465 mm x (D) 162 mm and have one door lockable and keys.
- (7) A weatherproof lock is provide by Cylinder Lock with Sealing cover.
- (8) Outdoor ODF body made of Aluminum or stainless steel thickness shall be not less than 1.5mm and powder coated 65 microns. All screw or nut made of stainless steel
- (9) Outdoor ODF bracket (I frame) made of Galvanizing Hot dip or Aluminum thickness shall be not less than 2.0 mm. and can be sliding.

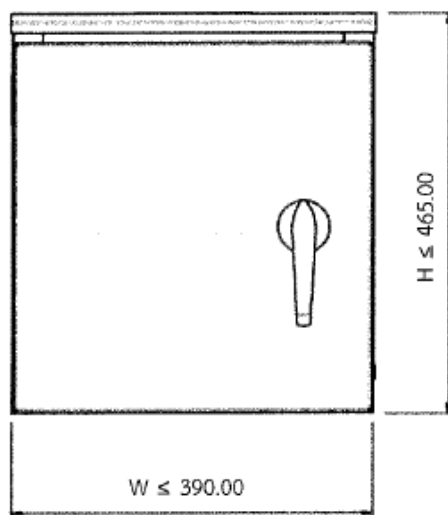

Font View

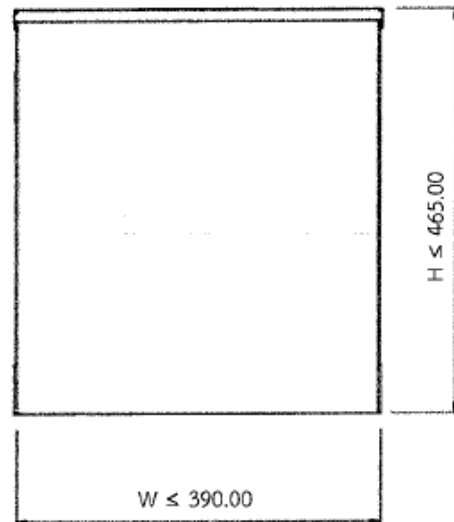

Back View

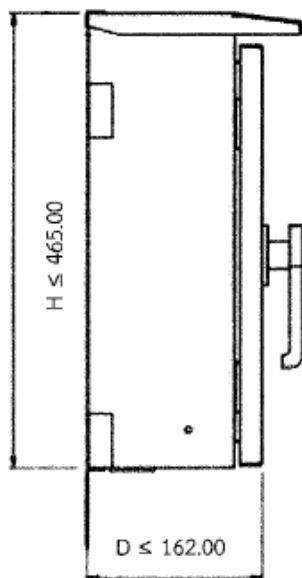

Side View

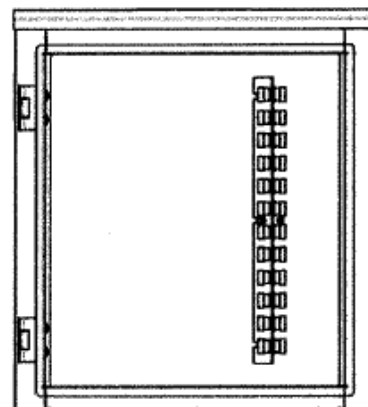

Inside View

Unit : mm.



# OUTDOOR WALL MOUNT 48-120F

## SPLICE PROTECTIVE SLEEVE



Splice sleeve for fiber-optic fusion splices can be used to rebuild the primary coating for fiber to provide protection at the fusion joint area.

Structure : Shrinkable sleeve

Stainless steel rod



### Generis Specifications :

Description	Typical diameter after heating $\Phi$ (mm)	Fusion Tube $\Phi$ (mm)	Length of the stainless steel rod l(mm)	Length of Sleeve l(mm)
45 mm	2.5	1.3	40	45
60 mm	2.5	1.3	55	60
Change of temperature	Temperature Cycle Cycles 1 cycle			- 40°C to +85°C 10 cycles 6 hr.

- End Specification -